



***I*LAND** **OWNERS MANUAL**



• IMPORTANT INFORMATION •

READ THIS MANUAL THOROUGHLY BEFORE USING

! WARNING

Use of this product involves **INHERENT RISKS OF INJURY OR DEATH**. Follow all instructions and safety information below and in owner's manual to reduce risks.

- This is not a lifesaving or personal flotation device.
- Never use under the influence of alcohol or drugs.
- Never tow with watercraft or any other vehicle.
- Use only on still water. Never use in rapids or on snow.
- Know and obey all laws for the waterway being used. Wear a properly fitted life jacket approved by your country's agency (USCG Type III, ISO, etc) when required.
- Do not use in shallow water or near shore, docks, pilings, swimmers, watercraft or any other obstacles; product can be slippery when wet.
- Never leave children unattended while in use.
- Always inspect item condition before each use. Do not use if damaged.

THANK YOU FOR BUYING THIS HO TUBE!
IF YOU HAVE ANY QUESTIONS ON THIS OR ANY HO SPORTS PRODUCT,
HYPERLITE OR BYERLY BOARDS, PLEASE CALL 1-800-938-4040

HO SPORTS CO. INC. 7926 BRACKEN PLACE SE
SNOQUALMIE, WA 98065 FAX (425) 867-5327
www.hosports.com

IMPORTANT PRODUCT INFORMATION

- PLEASE READ CAREFULLY BEFORE USE -

1. DO NOT TOW

HO Sports iLANDs are lots of fun when used properly. Under no circumstances should you ever try to tow your iLAND.



2. Inflating your iLAND

HO Sports recommends using the electric iSUP pump or the high pressure hand pump that comes with the purchase of your iLAND. Bali and Fiji come with the electric iSUP pump. Maui and Lanai come with the high pressure hand pump.

Remove the valve cover from the valve by unscrewing it ¼ turn counter-clockwise until the valve cover releases. Make sure the air release valve is in the 'up' position by pressing down with your thumb and turning to the right until it rebounds to the 'up' position when you release your finger. You can confirm the air release valve is in the 'up' position by pressing on the valve- if it depresses then returns to the 'up' position, the valve is in the proper position and your iLAND is ready to be inflated.

If using High Pressure Hand Pump – Attach the hose of the hand pump to the valve by inserting the hose and turning clockwise ¼ turn so the hose is securely attached to the valve. Stand on the base of the hand pump with one foot on each side and begin pumping air into your iLAND by depressing and retracting the handle on the pump. You will hear air flowing into your iLAND. Continue to pump air until the PSI gauge on the pump reaches the proper PSI (8-10 PSI for Maui / 5-7 PSI for Lanai).

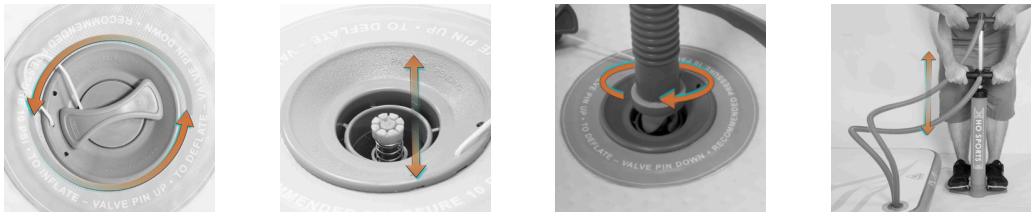

If using electric iSUP pump – Attach the hose of the electric iSUP Pump to the valve by inserting the hose and turning clockwise ¼ turn so the hose is securely attached to the valve. Turn the dial on the electric pump to the desired PSI (8-10 PSI for Bali & Fiji). Press the "ON" button. Pump will shut off automatically when the desired PSI is reached. (NOTE- pump can overheat if used for extended periods. After 20 minutes of use, allow pump to cool for 10 minutes)

Once you have achieved the proper PSI, return the valve cover by inserting it over the air release valve and turning the valve cover clockwise until it will not turn any more. This is the closed position.



3. Storage and Care

When not in use, rinse off with fresh water and store in a cool dry place out of direct sunlight. The iLAND should be deflated if it is not to be used for an extended period of time. Using common sense and reasonable care will greatly extend the life of this product. Bali and Fiji come with a nylon carry tote for storage and transport.

4. Construction and Warranty

This item is manufactured of the highest quality materials available and is designed to provide hours of fun when used under the proper conditions. Manufacturer's warranty covers defects and materials and workmanship for a period of one year.