

SureShade™ Bimini System with QC Battery Pack

Installation and Owner's Manual

(For Aftermarket Applications)

Table of Contents

- Introduction 2
- Safety 2
- Parts List 3
- Resources Required 4
- Preparation 4
 - Removal of Manual Bimini Frame 4
- Installation 4
 - Touch-sensitive Controller and Battery Receiver 11
 - Test Electrical Connections 14
 - Touch Controller and Nose Mount Cap 15
 - Canvas Top 16
- Bimini Top Positions 17
 - Fully Closed (Down)—Towing Position 17
 - Vari-pitch—For Water Use Only 17
 - Radar—For Water Use Only 17
 - Fully Opened (Up)—For Water Use Only 17
- Operation 18
- Charging the Battery 20
- Troubleshooting 21
 - Manual Override 21

Complete System Assembly - QC Battery Kits

Part #	Description
2021133084	Silver - No Canvas
2021133085	Black - No Canvas
2021133086	Silver - Black Canvas
2021133087	Black - Black Canvas
2021133088	Silver - Beige Canvas
2021133089	Black - Beige Canvas
2021133090	Silver - Burgundy Canvas
2021133091	Black - Burgundy Canvas
2021133092	Silver - Gray Canvas
2021133093	Black - Gray Canvas
2021133094	Silver - Navy Blue Canvas
2021133095	Black - Navy Blue Canvas
2021133096	Silver - Pacific Blue Canvas
2021133097	Black - Pacific Blue Canvas
2021133098	Silver - Green Canvas
2021133099	Black - Green Canvas

- Maintenance 23
 - Fabric Care 23
 - Storage or Storm Position 23
 - Winter Storage 23
- Wiring Diagram 24
- Notes 25



SureShade™ Bimini System with QC Battery Pack Installation and Owner's Manual (For Aftermarket Applications)

Introduction

The SureShade™ Bimini System with Quick Connect (QC) Battery Pack is an electric actuator-driven bimini top powered by a 20V DC rechargeable battery. The system can be operated with a two-button touch-sensitive controller or with a Bluetooth® compatible app.

A basic power bimini system with a rechargeable battery pack (2021133084—silver or 2021133085—black anodized framework) consists of all necessary components except for a canvas top and protective boot.

Complete power bimini systems with a rechargeable battery pack (2021133086 - 2021133099, silver or black) consists of a color-matching basic power bimini system (2021133084—silver or 2021133085—black) and the selected canvas color with matching protective boot.

The SureShade™ Bimini System with Quick Connect (QC) Battery Pack is designed to be installed on a pontoon boat that has never had a bimini system installed or onto a pontoon boat to replace a currently installed manual bimini system.

Additional information about this product can be obtained from lci1.com/support or by using the LippertNOW app. Replacement kits can be ordered from <https://store.lci1.com/> or by using the LippertNOW app.

The LippertNOW app is available for free on Apple App Store® for iPhone® and iPad® and also on Google Play™ for Android™ users.

App Store® and iPad® are registered trademarks of Apple Inc.

Google Play™ and Android™ are trademarks of Google Inc.

For information on the assembly or individual components of this product, please visit:

<https://support.lci1.com/sureshade-power-bimini> .

NOTE: Images used in this document are for reference only when assembling, installing and/or operating this product. Actual appearance of provided and/or purchased parts and assemblies may differ.

Safety

Read and fully understand all instructions before installing or operating this product. Adhere to all safety labels.

This manual provides general instructions. Many variables can change the circumstances of the instructions, i.e., the degree of difficulty, operation and ability of the individual performing the instructions. This manual cannot begin to plot out instructions for every possibility, but provides the general instructions, as necessary, for effectively interfacing with the device, product or system. Failure to correctly follow the provided instructions may result in death, serious personal injury, severe product and/or property damage, including voiding of the LCI limited warranty.

⚠ WARNING

THE “WARNING” SYMBOL ABOVE IS A SIGN THAT A SAFETY RISK IS INVOLVED AND MAY CAUSE DEATH OR SERIOUS PERSONAL INJURY AND/OR SEVERE PRODUCT OR PROPERTY DAMAGE IF NOT ADHERED TO SAFELY AND WITHIN THE PARAMETERS SET FORTH IN THIS MANUAL.

⚠ WARNING

DO NOT FULLY OPEN THE BIMINI FRAME WITHOUT THE CANVAS TOP INSTALLED WHEN TESTING PRODUCT FOR PROPER OPERATION. OPENING THE BIMINI FRAME WITHOUT THE CANVAS TOP INSTALLED WILL RESULT IN SEVERE PRODUCT DAMAGE. ONLY FULLY OPEN THE BIMINI FRAME WITH THE CANVAS TOP INSTALLED.

⚠ CAUTION

THE “CAUTION” SYMBOL ABOVE IS A SIGN THAT A SAFETY RISK IS INVOLVED AND MAY CAUSE PERSONAL INJURY AND/OR PRODUCT OR PROPERTY DAMAGE IF NOT SAFELY ADHERED TO AND WITHIN THE PARAMETERS SET FORTH IN THIS MANUAL.

⚠ CAUTION

ALWAYS WEAR APPROPRIATE PERSONAL PROTECTIVE EQUIPMENT (PPE) WHEN PERFORMING SERVICE, MAINTENANCE OR INSTALLATION PROCEDURES.

Parts List

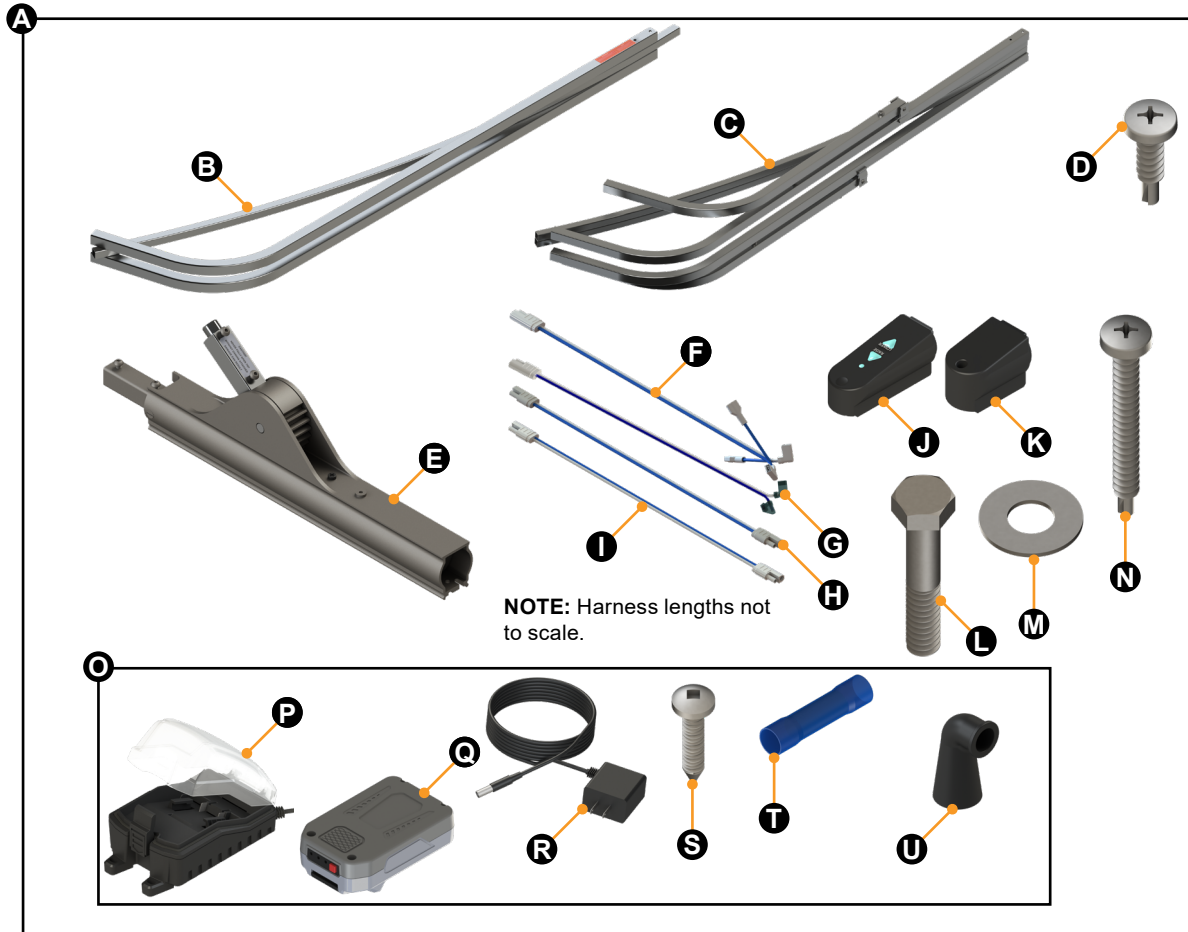

Complete Bimini System - QC Battery Pack Kit			
Letter	PN	Description	Qty
Kit-A	2021133084	Frame System - NC (Silver)	1
	2021133085	Frame System - NC (Black)	1
B	859602	Front Frame Assy (Silver)	1
	859605	Front Frame Assy (Black)	1
C	859603	Rear Frame Assy (Silver)	1
	859606	Rear Frame Assy (Black)	1
D	853955	Screw, #8-18 x 1/2" PH SLFDR	10
E	861675	Actuator, 1 1/4" (Silver)	2
	861676	Actuator, 1 1/4" (Black)	2
F	2020328732	Controller Harness, 27"	1
G	2020328733	Actuator Harness, 27"	1
H	2021130356	Side Frame Wire Harness, 7'	2

Complete Bimini System - QC Battery Pack Kit			
Letter	PN	Description	Qty
I	2021130357	Center Wire Harness, 7'	1
J	2020329389	Touch Controller	1
K	2021010666	Nose Mount Cap	1
L	853951	Bolt, 5/16"-18 x 1 3/4" Hex	4
M	853952	Washer, 5/16" Flat	4
N	2021106700	Screw, #8-18 x 1 1/2" PH SLFDR	2
O	2021131539	Bimini Battery Components	1
P	2021099702	Bimini Battery Receiver	1
Q	2021131294	Battery, 20V, Rechargeable	2
R	2021131295	Wall Charger, 20V Battery	1
S	381473	Screw, #10-12 x 1" PNH SQD	3
T	853982	Butt Conn., Insul., 14-16 AWG	2
U	2023001135	Strain Relief Elbow, Flared	1

NOTE: Part numbers are shown for identification purposes only. Not all parts are available for individual sale. All parts with a link to the Lippert Store can be purchased.

SureShade™ Bimini System with QC Battery Pack Installation and Owner's Manual (For Aftermarket Applications)

Resources Required

- 1-2 persons, depending on task
- Electric or cordless drill or screw gun
- #2 Phillips drive bit
- #3 square drive bit
- 5/32" hex wrench
- 1/2" wrench
- 9/16" wrench
- Wire cutter
- Wire stripper
- Wire crimper

Preparation

Removal of Manual Bimini Frame

If an installed manual bimini system (Fig.1) is being replaced, do as follows:

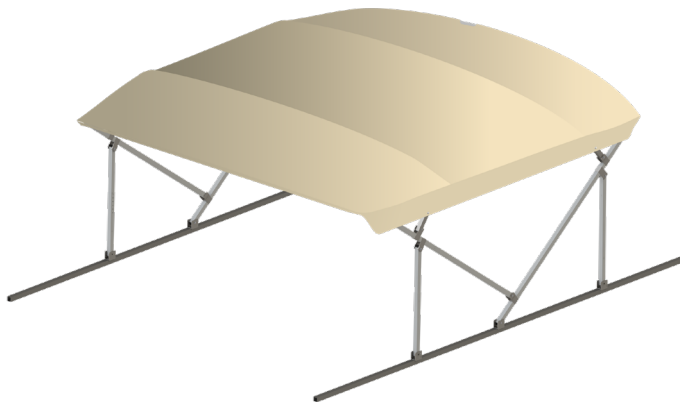

Fig.1

1. For ease of removal, retract the manual bimini into its fully closed position (Fig.2).

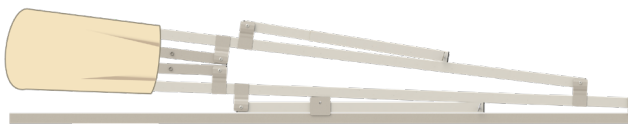

Fig.2

2. Remove all bimini frame struts from their H-brackets (Fig.3).
3. With assistance, lift the bimini frame off of the boat and set aside.

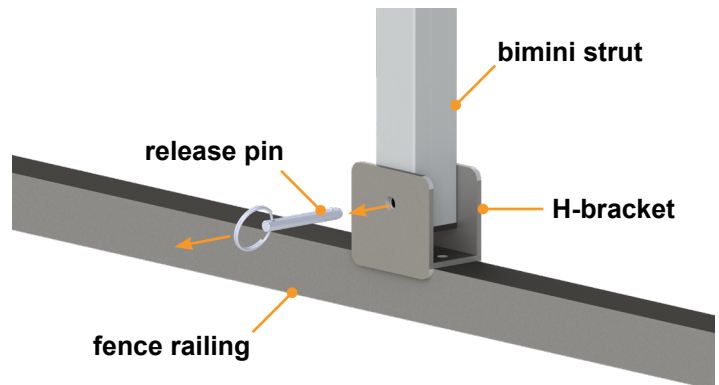

Fig.3

4. Remove all H-brackets from the fence railing (Fig.4).

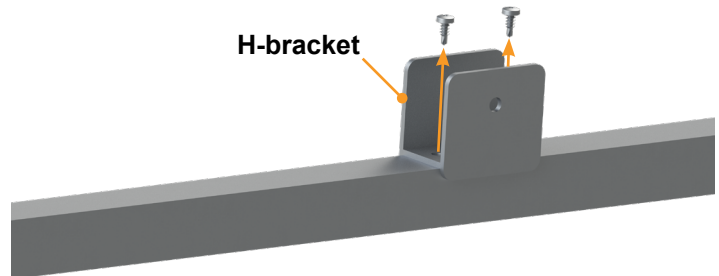

Fig.4

Installation

Actuators and Bimini Frame

When installing the complete power bimini system onto the boat's railing:

- Make sure the 20V rechargeable battery is fully charged. Refer to Charging the Battery section.
- While facing the bow (front) of the boat from the helm, there is a starboard—right-handed (RH)—and a port—left-handed (LH)—actuator.
- The starboard actuator is pre-wired to the touch controller.
- Both actuators will be electrically connected by a wire harness installed through the rear frame assembly.

SureShade™ Bimini System with QC Battery Pack Installation and Owner's Manual (For Aftermarket Applications)

1. Insert the starboard rear frame assembly (Fig.5A) over the starboard actuator's rear handle (Fig.5B). Do **NOT** secure frame to actuator with screws at this time.

NOTE: Actuator electrical harness not shown for clarity.

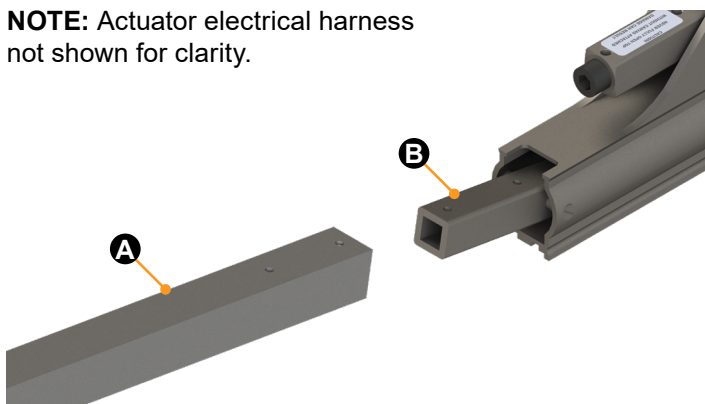

Fig.5

2. Place the starboard frame-actuator assembly onto the boat's fence railing.

A. Proper position is generally determined by locating the assembly so that when the top is down, the struts are just behind the rear seats. Too far forward and the top will interfere with rear seating; while too far aft will provide less shade to the front of the boat.

B. When properly positioned, use a pencil and trace a line across the front of the actuator (Fig.6).

3. Repeat step 2 for the port actuator and port rear frame assembly.

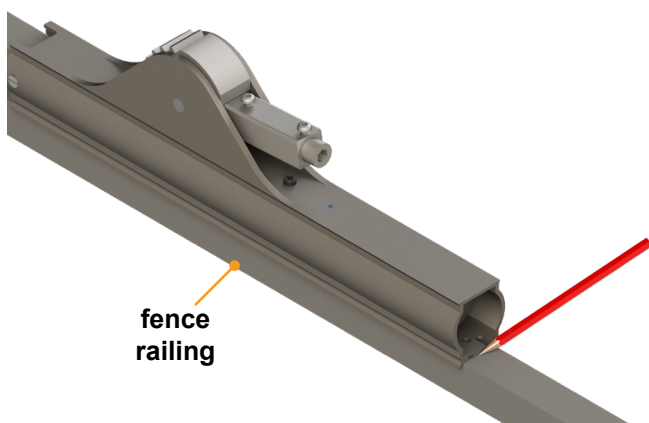

Fig.6

4. Put a tape measure on the pencil line made in previous steps 2 and 3.

A. Measure back $\frac{1}{2}$ " and $16\frac{1}{2}$ " and mark (Fig7).

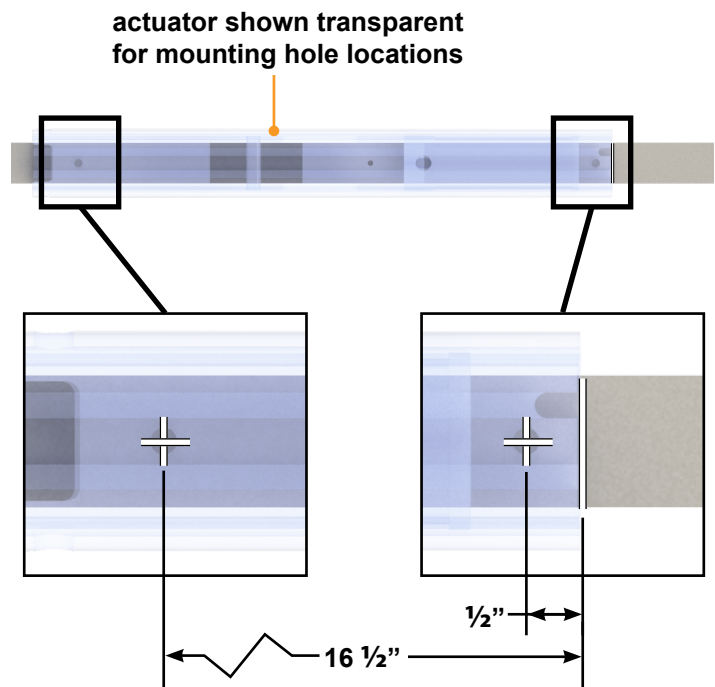

Fig.7

B. From the edge of the actuator, measure out $\frac{1}{2}$ " and mark at the center of the railing's width to locate the controller's wire access hole location (Fig.8A).

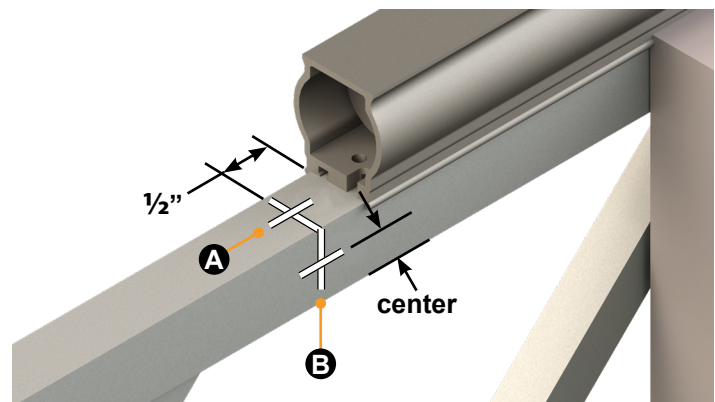

Fig.8

SureShade™ Bimini System with QC Battery Pack Installation and Owner's Manual (For Aftermarket Applications)

C. Ninety-degrees opposite the top wire access hole (Fig.8A), mark in the center of the deck-side surface of the railing to locate the rechargeable battery cable's elbow shroud access hole (Fig.8B).

⚠ CAUTION

DO NOT DRILL THROUGH EXISTING ELECTRICAL WIRING. DRILLING THROUGH EXISTING ELECTRICAL WIRING CAN RENDER SOME COMPONENTS INOPERABLE. SOME BOATS HAVE WIRES RUNNING THROUGH THE RAILING. DRILL HALF WAY THROUGH AND INSPECT FOR EXIST MAKE SURE YOU ARE CLEAR OF ANY WIRES.

D. Use a drill with a $\frac{3}{8}$ " bit to drill both holes in the center of the frame at the previously marked (step A) locations (Fig.7).

NOTE: These holes need to go all of the way through the rear frame tube.

E. On the **starboard** railing **ONLY**, use a drill with a $\frac{1}{2}$ " bit to drill two holes in the center of the frame (Fig.9A and B) at the previously marked (steps B and C) locations (Fig.8A and B).

NOTE: These holes only go through the wall of the tube, **NOT** all of the way through the tube.

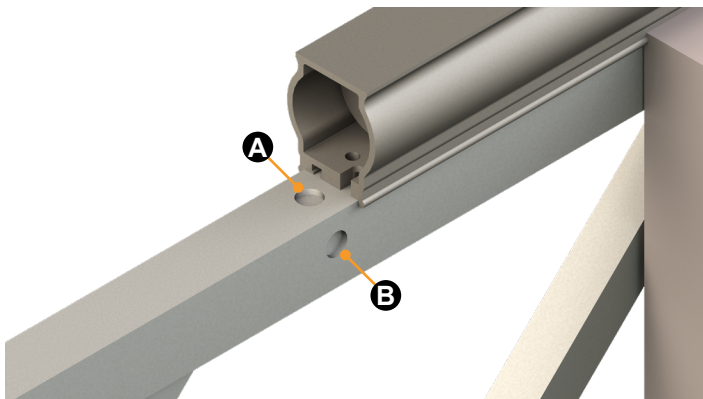

Fig.9

5. Assemble the supplied $\frac{5}{16}$ " flat washer (Fig.10A) onto the supplied $\frac{5}{16}$ "-18 x $1\frac{3}{4}$ " hex bolt (Fig.10B).

6. Install the starboard actuator on top of the fence railing where the dry-fit markings were made (step 4) (Fig.7).

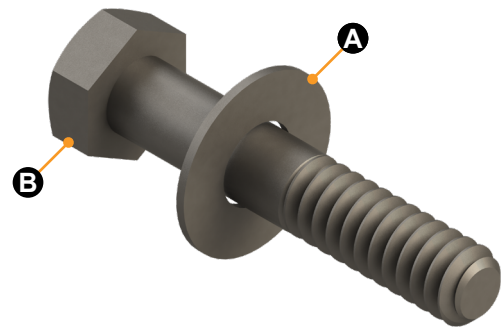

Fig.10

⚠ CAUTION

DO NOT CUT OR NICK ANY ELECTRICAL WIRE INSULATION. CUT OR NICKED WIRE INSULATION CAN EXPOSE BARE WIRE TO CORROSION AND/OR AN ELECTRICAL SHORT RESULTING IN A LOSS OF POWER.

NOTE: Use care to keep the touch controller wire harness inside of the wire channel to prevent any pinching, crimping or cutting of the wires.

7. Install assembled bolts (Fig.11A and B) into the previously drilled bottom holes (step 4.D.) of the railing and thread into the actuator.

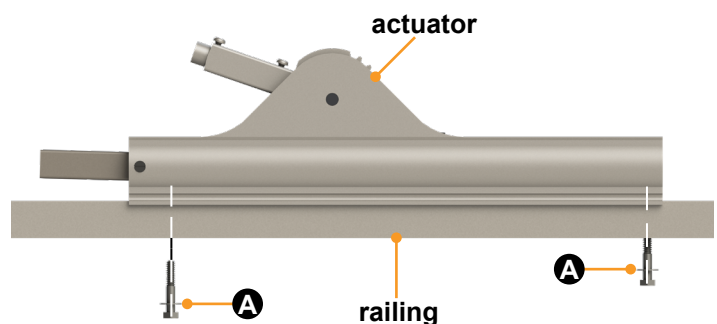

Fig.11

8. Use a $\frac{1}{2}$ " wrench on the bolts to fasten down the actuator assembly to the railing.

9. Repeat steps 5-8 to install and secure the port actuator.

⚠ CAUTION

DO NOT PINCH, CUT OR NICK ANY ELECTRICAL WIRE INSULATION. PINCHED, CUT OR NICKED WIRE INSULATION CAN EXPOSE BARE WIRE TO CORROSION AND/OR AN ELECTRICAL SHORT RESULTING IN A LOSS OF POWER.

10. Install starboard/port frame wire harnesses and starboard/port rear frame assemblies.

A. Run a starboard frame wire harness (Fig.12A) through the starboard rear frame assembly (Fig.12B).

B. Connect the bottom end of the side frame wire harness (Fig.12C) to the starboard actuator wire harness (Fig.12D).

C. Slip the starboard rear frame assembly over the starboard actuator's rear handle—using care not to pinch any electrical wires.

D. Use a $\frac{5}{32}$ " hex wrench to secure the frame in-place with two $\frac{1}{4}$ "-20 x $\frac{5}{16}$ " provided screws (Fig.12E).

11. Repeat steps 10.A-D to install the port frame wire harness and port rear frame assembly and to secure the port actuator to the railing.

12. Install center wire harness and connecting bows.

A. Feed one end of the center wire harness (Fig.13A) through a center connecting bow (Fig.13B) until enough harness extends at both ends for connecting to the starboard and port side frame harnesses.

B. Connect the starboard and port ends of the center wire harness to the starboard (Fig.13C) and port frame wire harnesses respectively.

C. Slip the center connecting bow (Fig.13D) into the starboard (Fig.13E) and port rear frame struts.

NOTE: Use care when inserting a center bow into the rear frame struts to avoid pinching or cutting any wires.

D. Slip a center connecting bow into the starboard and port middle frame struts (Fig.13).

E. Make sure the center bows are evenly adjusted to accommodate the width of the boat such that the center bows do not pull in or push out on the struts.

F. Fasten all struts and bows together with the provided #10 self-drilling Phillips screws (Fig.13F).

I. Install one screw on each starboard and port rear strut where shown in figure 13.

II. Install two screws on each starboard and port middle strut where shown in figure 13.

G. Slip the starboard front frame (Fig.14A) over the starboard actuator's gear handle (Fig.14B).

I. Use a $\frac{5}{32}$ " hex wrench to secure the frame in-place with two $\frac{1}{4}$ "-20 x $\frac{5}{16}$ " provided screws (Fig.14C).

II. Repeat this step to secure the port front frame over the port actuator's gear handle.

H. Insert a center connecting bow (Fig.15A) into the starboard and port front frame struts (Fig.15).

I. Make sure the center bow is evenly adjusted to accommodate the width of the boat such that the center bow does not pull in or push out on the struts.

II. Install one #10 self-drilling Phillips screw (Fig.15B) on each starboard and port front strut where shown in figure 15.

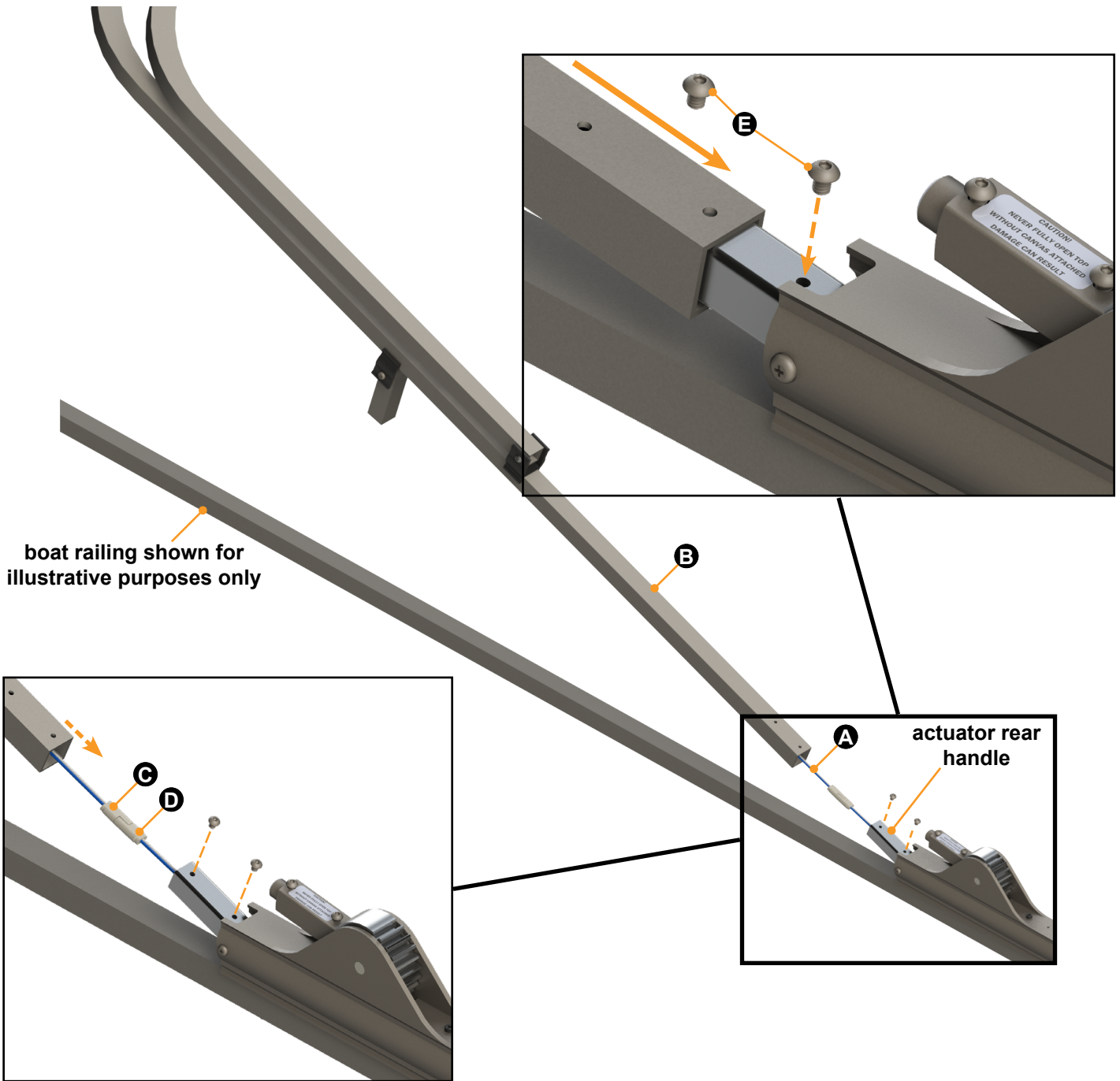

Fig.12

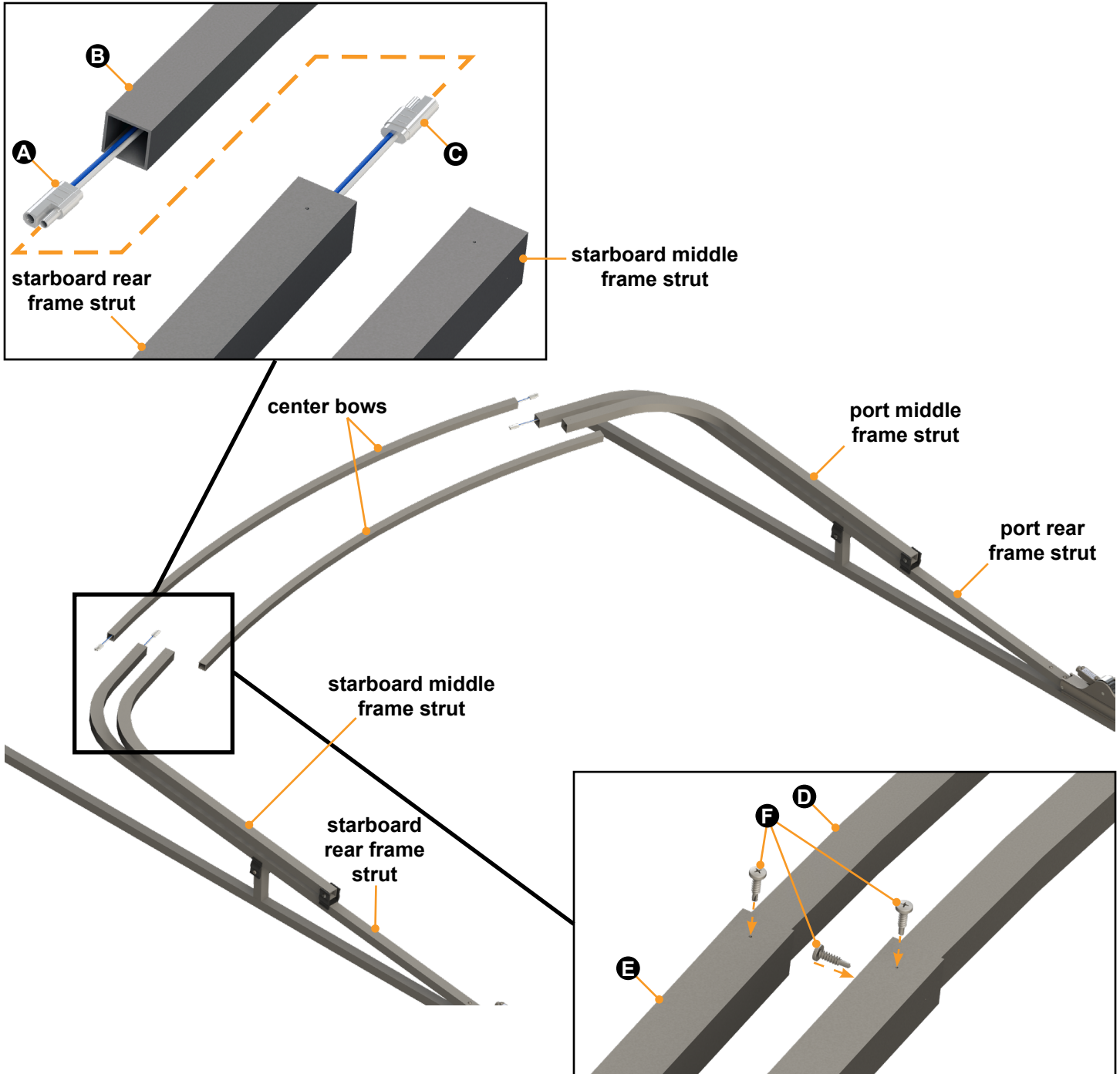

Fig.13

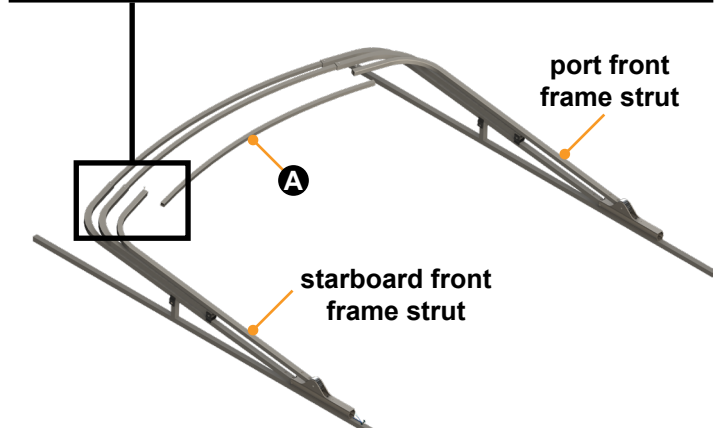
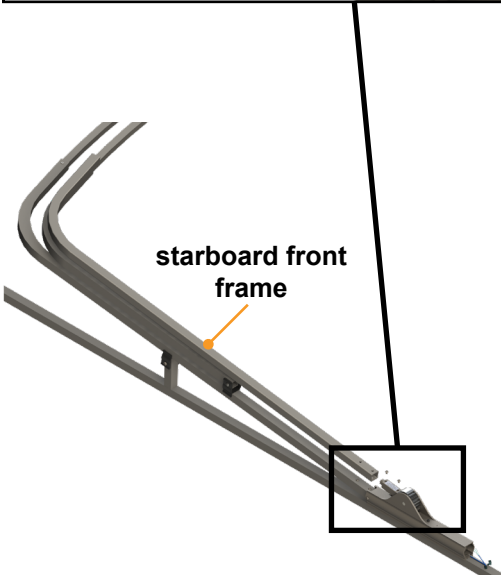
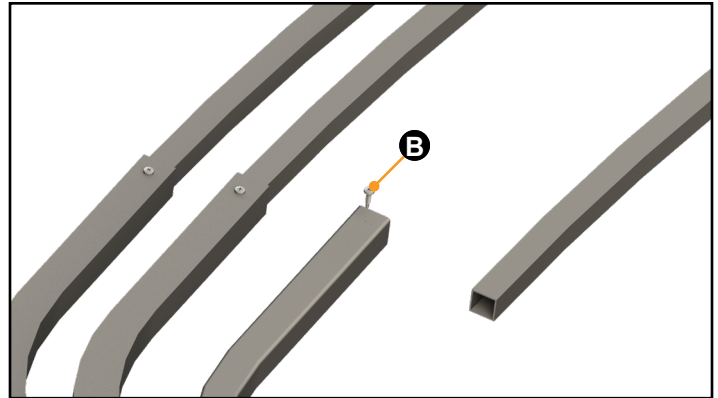
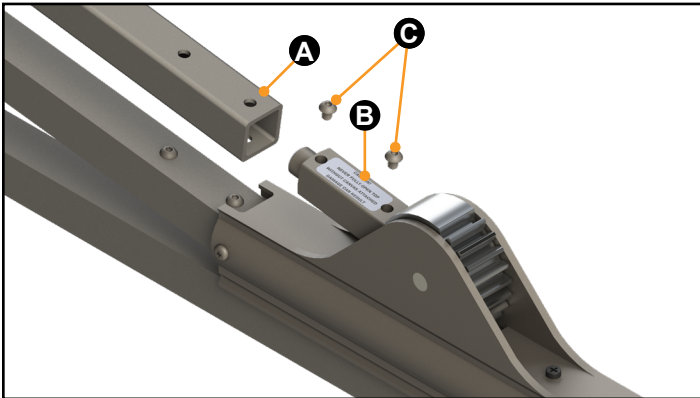

Fig.15

Fig.14

⚠ CAUTION

DO NOT ENERGIZE THE SYSTEM DURING INSTALLATION. AN ENERGIZED SYSTEM DURING INSTALLATION CAN CAUSE PRODUCT AND/OR PERSONAL INJURY. REMOVE RECHARGEABLE BATTERY FROM BATTERY RECEIVER BEFORE INSTALLING THE ELECTRICAL HARNESS TO AVOID POSSIBLE PRODUCT AND/OR PERSONAL INJURY.

Touch-sensitive Controller and Battery Receiver

The touch controller requires an electrical connection to the battery receiver's power cable and physical attachment to the boat's railing.

If the rechargeable battery is plugged into the battery receiver, remove the battery before installing the box.

Install the battery receiver and power cable as follows:

1. Locate and mount the battery receiver by the helm as far forward as possible and clear of any walking path or door.
2. Position the hinged rear of the battery receiver with enough clearance for the power cord to travel up towards the touch controller without the harness being pinched. Make sure the battery receiver lid has enough room to open for ease of access to the rechargeable 20V, 2.0 Ah battery.
3. Use a #3 square drive bit with the three supplied #10-12 UNC screws (Fig.16A) to secure the battery receiver (Fig.16B).

⚠ CAUTION

DO NOT REMOVE ANY PORTION OF THE BACKING TAPE PRIOR TO FINAL INSTALLATION. EXPOSURE TO CONTAMINANTS CAN MAKE THE ADHESIVE TAPE INEFFECTIVE.

4. Dry-fit the power cord and foam tubing (Fig.17A) from the battery receiver, up the fence, along the side of the railing and through the side wire access hole to the touch controller. See figure 17 for example area.

NOTE: The battery receiver comes with pre-installed foam tubing around the power wires. The foam tubing has an adhesive protective backing tape. Do **NOT** remove the tape until final installation.

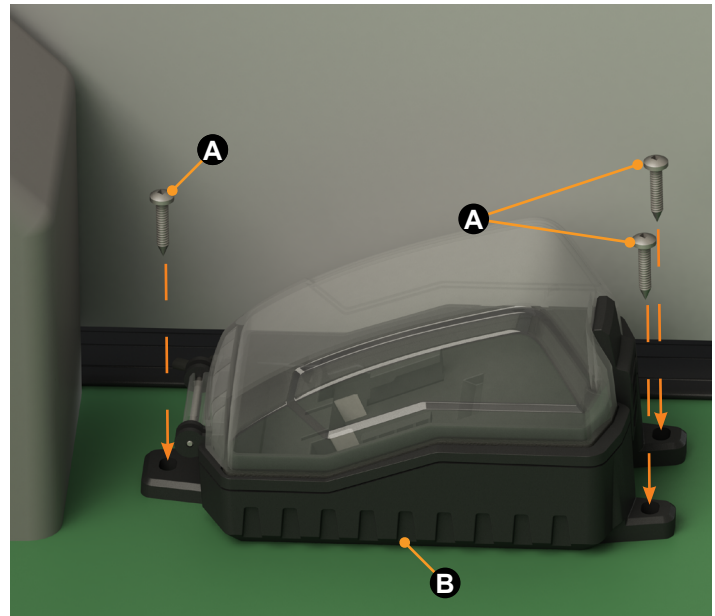

Fig.16

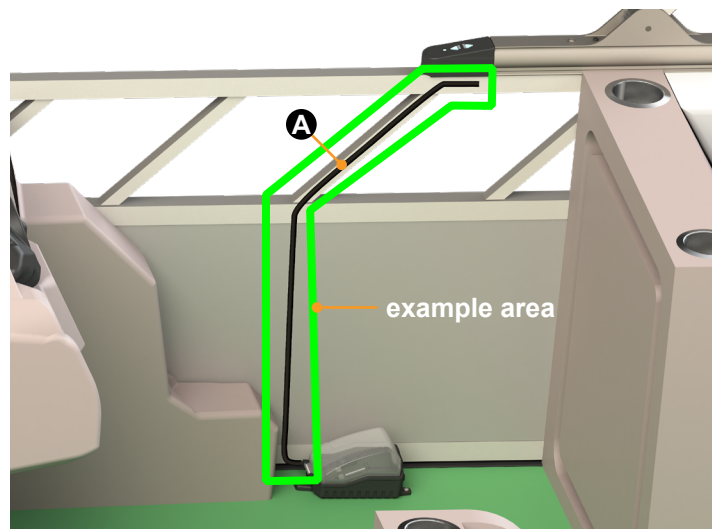

Fig.17

5. Make sure there is enough battery receiver power cord length to allow for trimming and still reach the touch controller's wiring.

⚠ CAUTION

DO NOT CUT OR NICK ANY ELECTRICAL WIRE INSULATION. CUT OR NICKED WIRE INSULATION CAN EXPOSE BARE WIRE TO CORROSION AND/OR AN ELECTRICAL SHORT RESULTING IN A LOSS OF POWER.

6. When the proper length of battery receiver power cord has been determined, cut the cord to the determined length.

A. Carefully trim away the outer, protective foam tubing at the location where the tubing will meet up against the underside of the fence railing at the wire access hole. Do **NOT** cut or nick any insulation covering the interior wires.

B. Form the exposed wires into a hook shape (Fig.18) so they will feed successfully through the elbow shroud.



Fig.18

I. Feed the wires all the way through the elbow shroud from the wide end to the narrow end (Fig.19).

II. Pull the wires taut on the narrow end of the elbow shroud to snug the elbow against the foam tube.



Fig.19

III. Tuck the cut end of the foam tube into the elbow shroud for neatness and protection (Fig.20).



Fig.20

SureShade™ Bimini System with QC Battery Pack Installation and Owner's Manual (For Aftermarket Applications)

C. Thread the battery receiver cord power wires up through the deck-side fence railing's wire access hole (Fig.21).

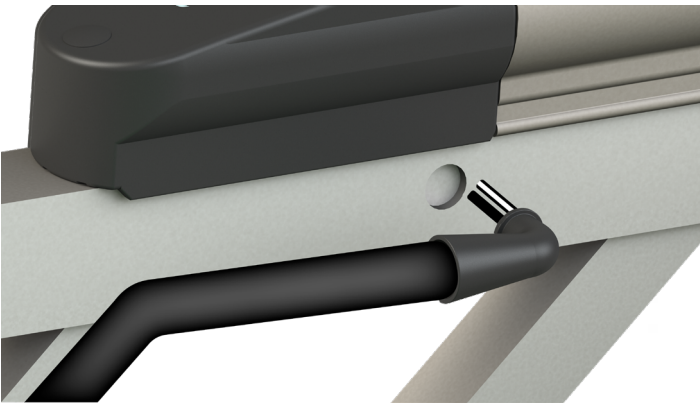

Fig.21

D. Tuck the narrow end of the elbow shroud into the wire access hole of the fence's railing (Fig.22A).

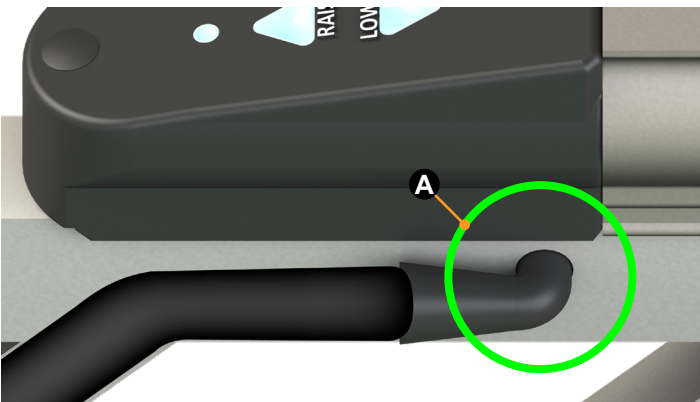

Fig.22

7. Inspect the dry-fit route (step 4) for the battery receiver harness to make sure all of the surfaces are dry and free of oils, dirt and grime. If necessary, clean all harness route surfaces.

⚠ CAUTION

EXPOSURE TO CONTAMINANTS CAN MAKE THE ADHESIVE TAPE INEFFECTIVE. USE CARE WHEN REMOVING ANY PORTION OF THE BACKING TAPE.

8. Remove the adhesive backing tape from the foam tubing.

A. Carefully retrace the dry-fit route (step 4) with the adhesive backing of the foam tubing.

B. Make sure to press firmly and evenly along the length of the cord so that the adhesive backing tape takes hold.

9. Prepare cord power wires for connection as follows:

A. Use a wire cutter to cut the connectors off of the touch controller's black (-) (Fig.23A) and red (+) (Fig.23B) wires where indicated (orange cut line).

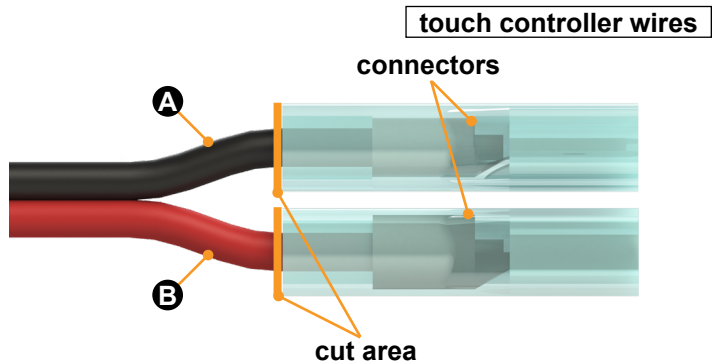

Fig.23

B. Use a wire stripper to remove 1/4" of insulation (Fig.24) from the ends of the black (-) (Fig.24A) and red (+) (Fig.24B) wires.

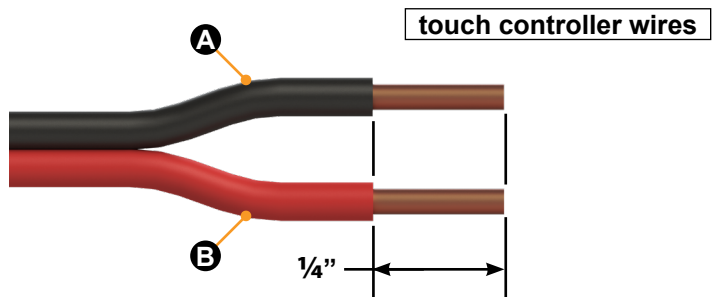

Fig.24

C. With the battery receiver cord power wires threaded up through the fence railing's wire access hole, use a wire stripper to remove 1/4" of insulation from the ends of the black (-) (Fig.25A) and black/white (+) (Fig.25B) wires.

SureShade™ Bimini System with QC Battery Pack Installation and Owner's Manual (For Aftermarket Applications)

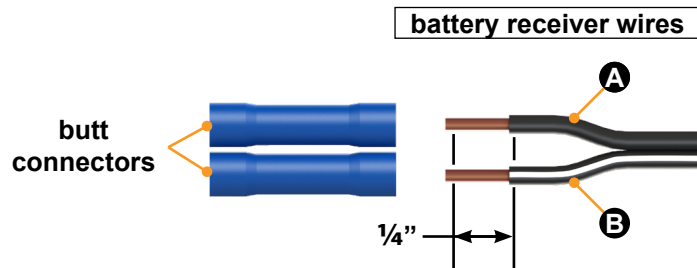

Fig.25

D. Slip a butt connector (Fig.25A) over each bare wire.

E. Use a crimping tool to crimp each butt connector's metal sleeve (green crimp area) onto the bare wire (Fig.25).

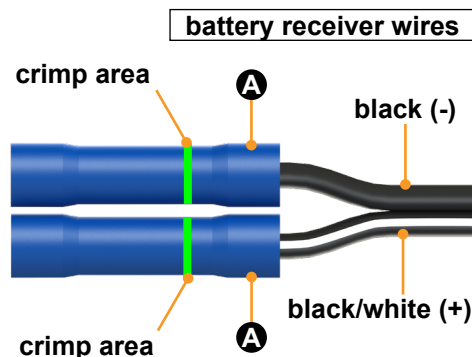

Fig.26

F. Insert the touch controller's black (-) (Fig.27A) wire into the butt connector on the battery receiver's black (-) (Fig.27B) wire.

G. Insert the touch controller's red (+) (Fig.20C) wire into the butt connector on the battery receiver's black/white (+) (Fig.20D) wire.

H. Use a crimping tool to crimp each butt connector's metal sleeve (green crimp area) onto the two bare wires (Fig.20).

NOTE: If desired, the butt connectors can be heat shrunk at this time to further protect the electrical connections from possible corrosion or disconnect.

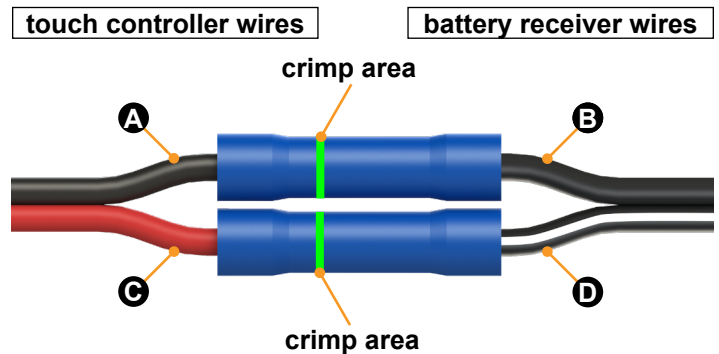

Fig.27

Test Electrical Connections

Before completing the installation of the QC battery pack, test the previously made electrical wire harness connections.

1. Check the power level of the rechargeable battery. See Operation section.
2. Insert a fully charged battery into the receiver (Fig.28).



Fig.28

3. Press and momentarily hold the touch controller's **RAISE** button (Fig.29A) until the bimini frame begins to rise.

A. If the bimini frame does **NOT** rise, release the button and remove the battery from the receiver.

I. Check the battery for charge level.

II. Check all electrical connections to make sure they are secure—not loose.

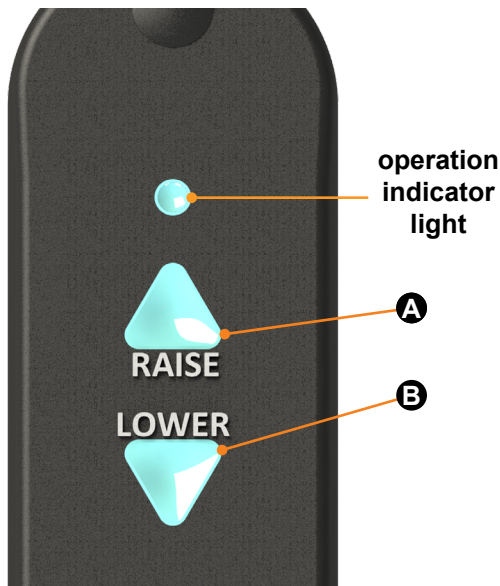

Fig.29

III. Inspect all wires for pinched, nicked or cut electrical wires.

IV. If necessary, charge battery, re-secure loose electrical connections and/or replace damaged electrical wire harnesses.

B. If the bimini frame rises, release the button.

C. Press and hold the touch controller's **LOWER** button (Fig.29B) until the bimini frame fully retracts to its fully closed position. See Bimini Top Positions section.

Touch Controller and Nose Mount Cap

1. Attach the touch controller (Fig.23) as follows:

CAUTION

DO NOT CUT OR NICK ANY ELECTRICAL WIRE INSULATION. CUT OR NICKED WIRE INSULATION CAN EXPOSE BARE WIRE TO CORROSION AND/OR AN ELECTRICAL SHORT RESULTING IN A LOSS OF POWER.

A. Carefully tuck excess harness wires into the open end of the touch controller and starboard actuator.

NOTE: Use care when tucking harness wires into the touch controller and starboard actuator to avoid pinching or cutting the harness wires.

B. Install the touch controller into the end of the starboard actuator while aligning the controller's base with the top of the boat's starboard fence railing (Fig.30).

C. Remove the protective cap (Fig.30A) over the touch controller's mounting hole.

D. Fasten the front of the touch controller to the boat's starboard railing with the provided #8-18 x 1 1/2" Phillips self-drilling screw.

E. Reinstall the previously removed (step C) protective cap (Fig.30A) over the mounting screw.

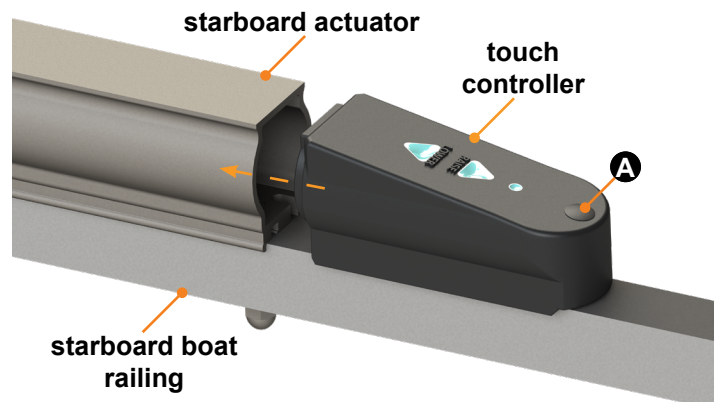

NOTE: Actuator and touch controller wire harnesses not shown for clarity.

Fig.30

2. Attach the nose mount cap (Fig.31) as follows:

A. Carefully tuck excess harness wires into the open end of the nose mount cap and port actuator.

NOTE: Use care when tucking harness wires into the nose mount cap and port actuator to avoid pinching or cutting the harness wires.

B. Install the nose mount cap into the end of the port actuator while aligning the cap's base with the top of the boat's port fence railing (Fig.31).

SureShade™ Bimini System with QC Battery Pack Installation and Owner's Manual (For Aftermarket Applications)

C. Fasten the front of the nose mount cap (Fig.31A) to the boat's port fence railing with the provided #8-18 x 1 1/2" Phillips self-drilling screw.

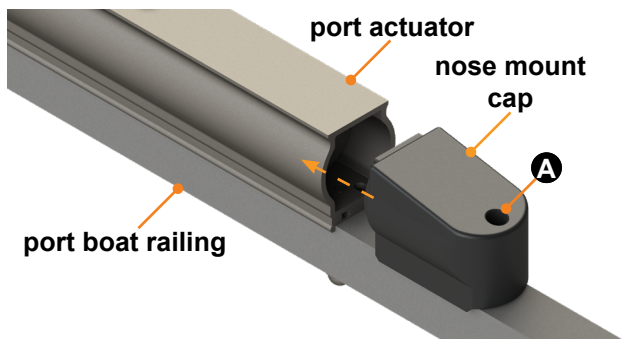

NOTE: Actuator wire harness not shown for clarity.

Fig.31

Canvas Top

The SureShade Power Bimini System with QC Battery Pack being installed is fully compatible with Lippert canvas and high speed mesh tops. Using other market tops may not be fully compatible with this bimini system, resulting in an improperly installed top that may cause poor bimini performance.

CAUTION

DO NOT POWER ACTUATORS TO THE FULL OPEN POSITION WITHOUT CANVAS INSTALLED. DAMAGE MAY OCCUR.

If the previously removed manual bimini frame and top was a Lippert system, the removed top may be compatible with the SureShade Power Bimini System with QC Battery Pack. The removed top, or the top that came with the new system, can be installed as follows:

1. With a fully charged battery installed in the battery receiver, use the touch controller to position the bimini frame into a partially raised position.
2. Unzip the rear, middle and front mounting pockets of the canvas top.
3. Place the canvas top over the bimini frame.
4. The rear of the bimini top has an access hole for a stern light. On newer canvas tops, the front of the top has a zippered storage pouch that is separate from the top's front zippered mounting pocket.

5. If a stern light is attached to the rear frame's bow, slip the bimini top's access hole over the light, then spread the top outward; aligning the rear zippered pouch over the bimini's rear bow frame.

6. Zip the rear canvas top pocket closed over the rear bimini frame bow.

7. Pull the middle zippered pocket of the canvas top over the middle frame bow, then zip it closed.

8. Pull the front zippered pocket of the canvas top over the front frame bow, then zip it closed.

9. Corner securing straps are provided to prevent undue billowing of the canvas top and for the attachment of accessories.

A. Corner securing straps are located at aft and bow port and starboard frame corners.

NOTE: Securing straps also prevent undue billowing of the canvas top when installing the boot.

B. Start at one canvas corner and tightly pull and wrap the securing strap around the bimini top strut and snap in-place (Fig.25). Repeat procedure as necessary for each securing strap.

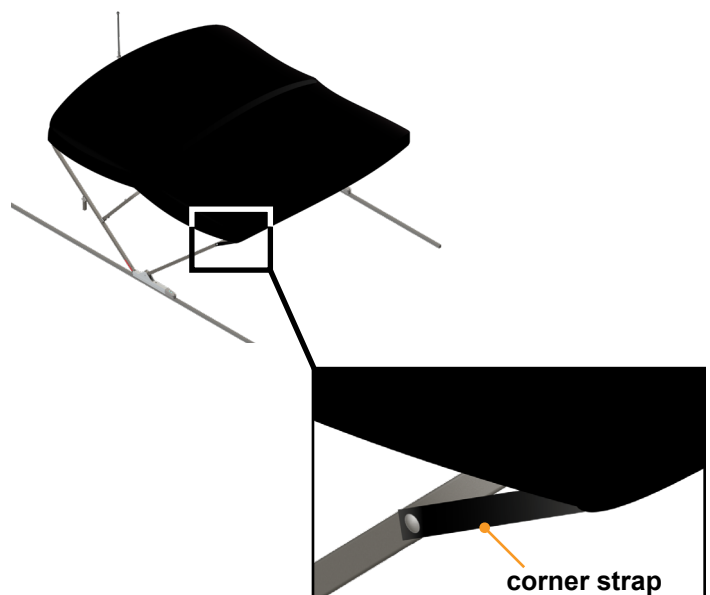

Fig.32

Bimini Top Positions

⚠ WARNING

DO NOT TRAILER OR TOW THE BOAT WITHOUT THE PROTECTIVE BOOT PROPERLY INSTALLED ON THE TOP AND WITHOUT THE TOP IN ITS FULL DOWN POSITION. TRAILERING OR TOWING THE BOAT WITHOUT THE TOP IN ITS FULL DOWN POSITION AND WITHOUT THE PROTECTIVE BOOT PROPERLY INSTALLED CAN CAUSE SERIOUS DAMAGE TO THE TOP'S FRAMEWORK, WHICH COULD CAUSE SEVERE PRODUCT AND/OR PROPERTY DAMAGE, INCLUDING SERIOUS PERSONAL INJURY.

⚠ WARNING

DO NOT OPEN OR OPERATE THE TOP IN EXCESSIVELY HIGH WINDS. HAVING THE TOP OPEN OR OPERATING THE TOP IN HIGH WINDS, REGARDLESS IF THE BOAT IS IN MOTION OR ANCHORED, CAN CAUSE SERIOUS DAMAGE TO THE TOP'S FRAMEWORK, WHICH COULD CAUSE SEVERE PRODUCT AND/OR PROPERTY DAMAGE, INCLUDING SERIOUS PERSONAL INJURY.

Fully Closed (Down)—Towing Position

Install protective boot.

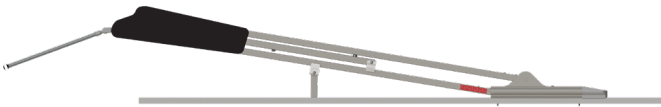

Vari-pitch—For Water Use Only

Remove protective boot.

Maximum water speed limit 5 MPH.

Used for improved shade protection from late-day sun.

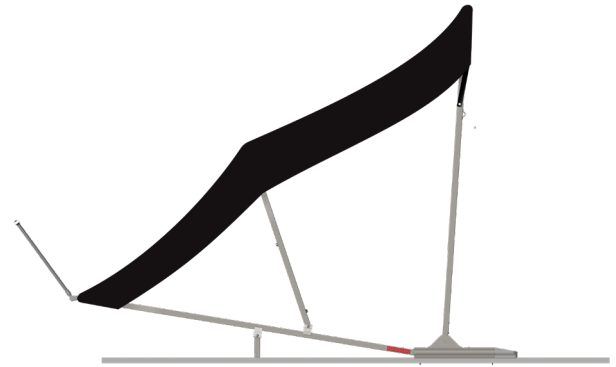

Radar—For Water Use Only

Install protective boot.

Maximum water speed limit 50 MPH.

NOT for trailering or towing.



Fully Opened (Up)—For Water Use Only

Remove protective boot.

Maximum speed limit 25 MPH.

NOTE: Do **NOT** open in excessively high winds.

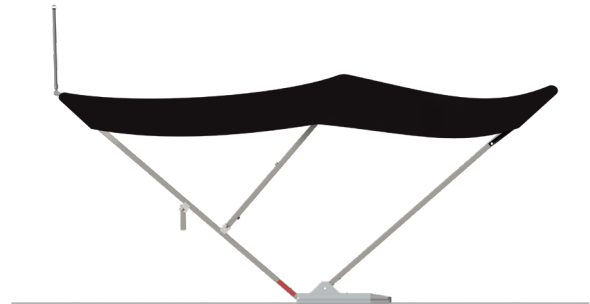

SureShade™ Bimini System with QC Battery Pack Installation and Owner's Manual (For Aftermarket Applications)

Operation

For first use after initial product installation, several operations or long periods of non-use, check the power level of the rechargeable battery.

1. Press and hold the power level button (Fig.33A). Power level indicator lights (Fig.33B) will turn on green to indicate the battery's level of charge:

- three lights = full-charge
- two lights = half-charge
- one light = low-charge
- no lights = no-charge

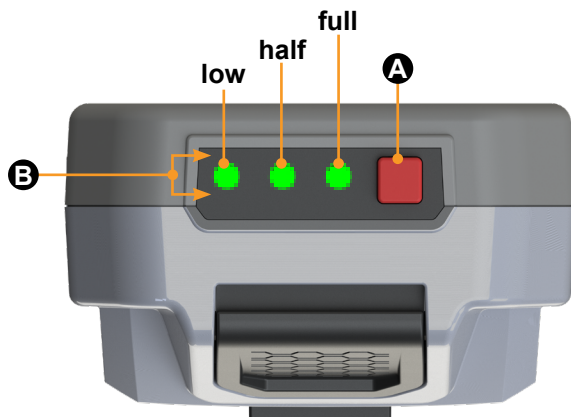

Fig.33

2. If necessary, use the provided battery charger to fully charge the battery. See Charging the Battery section.

3. Plug a fully charged battery into the battery receiver and close the lid.

NOTE: Always keep the battery receiver lid closed whether or not the battery is installed to protect electrical contact elements from water and other contaminants.

4. Remove any protective boot or restraints from the canvas top.

⚠ CAUTION

DO NOT POWER ACTUATORS TO THE FULL OPEN POSITION WITHOUT CANVAS INSTALLED. DAMAGE MAY OCCUR.

5. To operate the bimini system, use one of the following methods:

- Quick Connect (QC) touch controller
- SureShade Bluetooth® compatible app

NOTE: Do **NOT** fully open the bimini system without a canvas top installed or failure of the system will result.

A. To control the bimini system with the QC touch controller:

I. Press and hold the appropriate button (Fig.34A) until the desired position is reached and the actuators stop.

NOTE: The controller's operation indicator (Fig.34) will light when the controller is active.

II. Release the button.

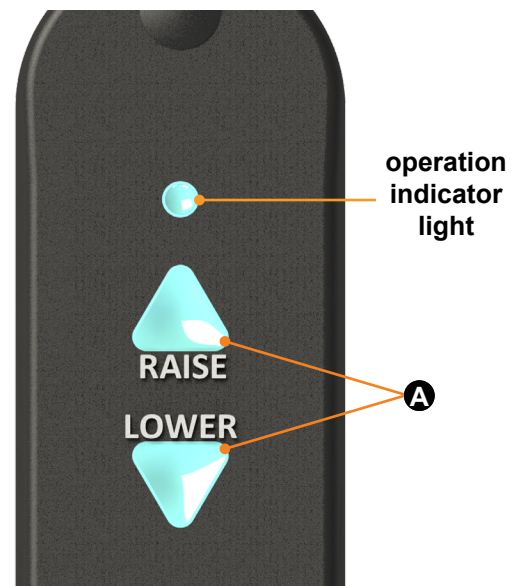

Fig.34

SureShade™ Bimini System with QC Battery Pack Installation and Owner's Manual (For Aftermarket Applications)

B. To control the bimini system with the SureShade Bluetooth® compatible app, download and install the SureShade Connect app from the Apple App Store® or Google Play® onto a smart device.

App Store® and iPad® are registered trademarks of Apple Inc.

Google Play™ and Android™ are trademarks of Google Inc.

NOTE: There is no operation indicator light on the app's control button screen (**Fig.35**).

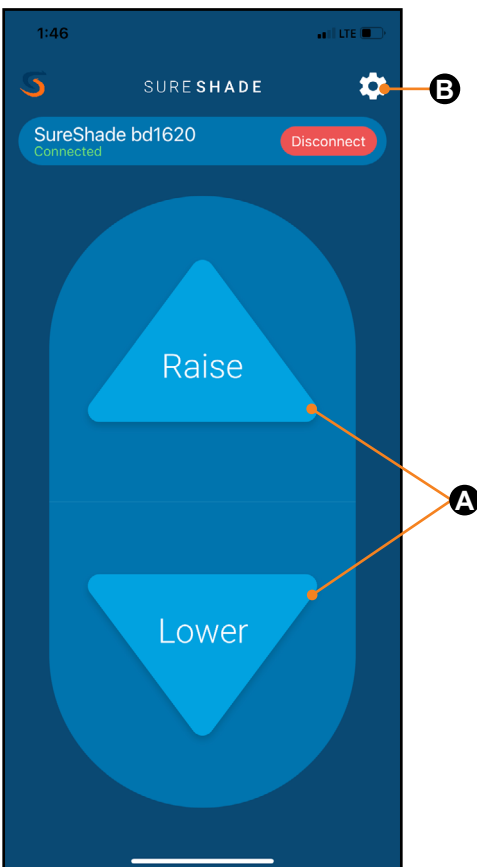

Fig.35

I. Follow all on-line prompts to install and pair the app to the controller.

II. Use the app control buttons (**Fig.35A**) to raise or lower the bimini system by applying continuous contact on the button until the desired position is reached, then release the button.

6. To un-pair (disconnect) the controller from a smart device, do as follows:

A. Open the app and go to the Raise and Lower button screen (**Fig.35**).

B. Tap the gear icon (**Fig.35B**) to access the Settings screen.

C. Follow the app's on-screen prompts to un-pair (disconnect) the controller from the app.

Charging the Battery

For first use after initial product installation, several operations or long periods of non-use, check the power level of the rechargeable battery (Operation section, step 1).

When necessary, recharge the battery with the wall charger (Fig.36A) as follows:

1. Retrieve the 20V rechargeable battery (Fig.36B) and turn it to access the charging port (Fig.36C) on the bottom.
2. Insert the 2-pronged wall charger into a standard 110V AC outlet (Fig.36D).

3. Fully insert the charger's barrel plug (Fig.36E) into the battery's charging port.
4. When all three power level indicator lights (Fig.33) turn on green, the battery is fully charged.
5. After the battery has been charged:
 - A. Remove the barrel plug from the battery.
 - B. Remove the charger from the outlet.

If desired, the fully charged battery can now be inserted into the battery receiver.

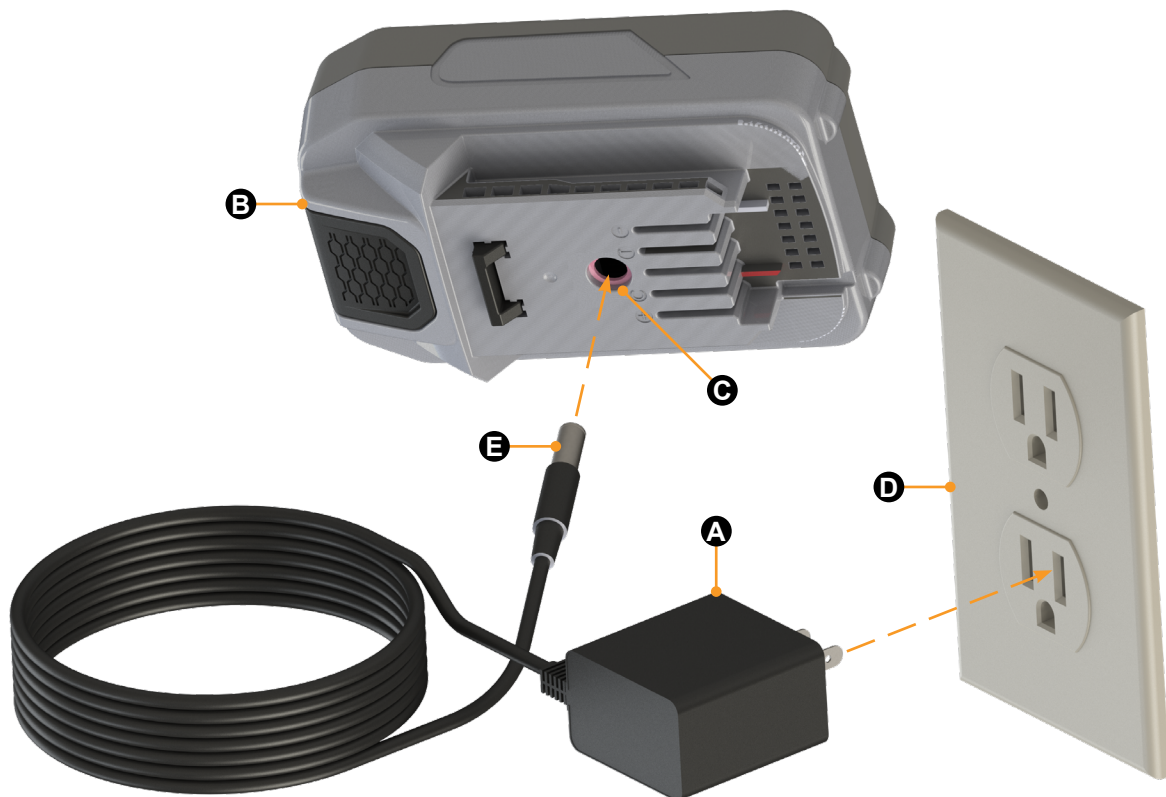

Fig.36

Troubleshooting

What is happening?	Why?	What should be done?
Top does not raise or lower/touch controller buttons do not respond.	No power.	If using the rechargeable battery; <ul style="list-style-type: none"> • check the battery's energy level, • recharge battery if necessary, • install charged battery. If using the app on a smart device; <ul style="list-style-type: none"> • make sure smart device is turned on, • make sure Bluetooth is turned on, • make sure the app is active. • then try controlling the actuators using the app. Make sure a charged battery is installed.
	Bad electrical harness.	Contact Lippert. Email: customerservice@lci1.com Phone: 432-LIPPERT (432-547-7378)
	Bad actuator.	
	Bad touch controller.	
	Bad electrical connection.	Check for loose or unconnected wires. Connect wires.
Pinched/cut harness wire.	Contact Lippert. Email: customerservice@lci1.com Phone: 432-LIPPERT (432-547-7378)	
Controller power indicator light not lit.	No electrical power.	Check rechargeable battery power level; recharge battery if necessary. Make sure a charged battery is installed.
	Bad operation indicator light.	Replace controller.
Canvas top sags.	Unzipped frame pocket.	Zip all frame pockets closed.
	Top not fully opened.	Fully open canvas top.

Manual Override

If the bimini system will not retract into the down or fully retracted position, a manual override of the bimini system **MUST** be done before towing or operating the pontoon. Perform a manual override of the bimini system as follows:

1. If a Lippert Bimini Top is installed, retrieve the 5/32" hex wrench and manual override instruction sheet from the canvas storage pocket.
2. Zip the storage pocket closed.
3. Unzip the front frame pocket of the canvas.
 - A. If available, have a second person push forward on the rear frame to relieve some pressure off of the canvas.
 - B. Hold up the rear and middle frames while the canvas is unzipped.

4. Place the rear frame and canvas in the down position (Fig.37).

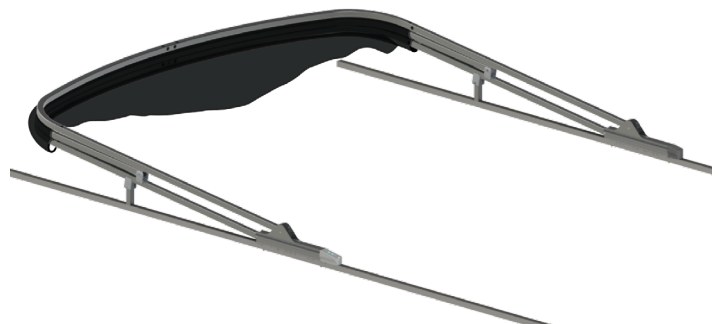

Fig.37

SureShade™ Bimini System with QC Battery Pack Installation and Owner's Manual (For Aftermarket Applications)

5. Use a 5/32" hex wrench (Fig.38A) to remove the two 1/4" hex cap screws (Fig.38B) located at each starboard and port front frame strut.

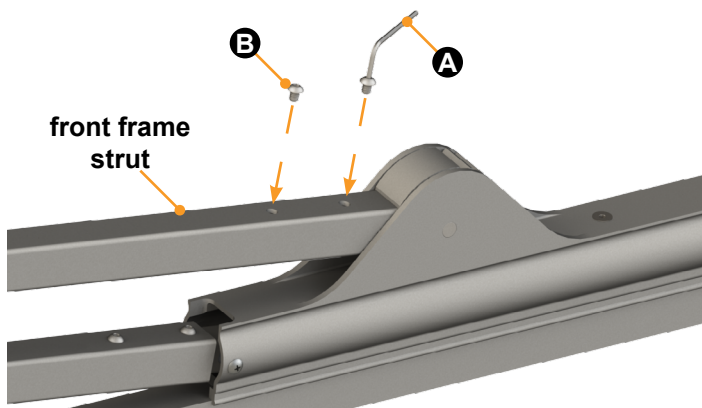

Fig.38

6. Separate the front frame (Fig.39A) from both actuator gear handles (Fig.39B).

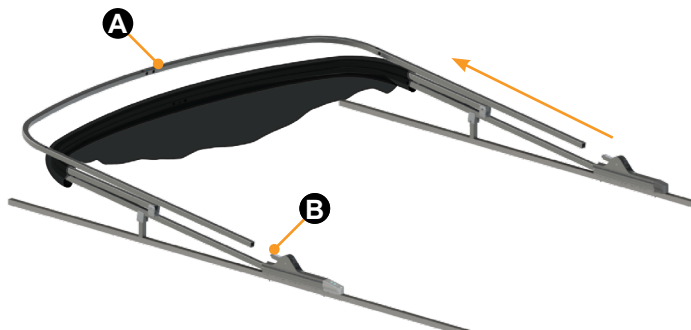

Fig.39

7. Reinstall the previously removed screws (step 5) into the actuator gear handles.

8. Return the hex wrench and instruction sheet to the canvas' front storage pocket.

9. Fully collapse the bimini frame by placing the front frame on top of the rear frame (Fig.40).

10. Zip the bimini top's front frame pocket over the loose front frame to help hold the frame in-place.

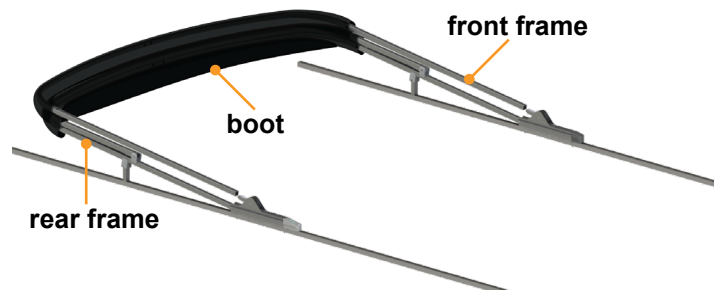

Fig.40

11. Secure the remainder of the front frame in-place with the protective boot (Fig.40), zip ties, hook-and-loop strips or with some other type of cordage.



SureShade™ Bimini System with QC Battery Pack Installation and Owner's Manual (For Aftermarket Applications)

Maintenance

Heat and sun will deteriorate any fabric top.

In Florida, leaving the top open all of the time—not folded back in the storage position—the top might last 5-6 years. Folding the top back and covering it with the protective boot when the pontoon is not in use, the boot may deteriorate, but it will protect the top's fabric.

In northern climates, heat won't affect the fabric as harshly. Still, folding the top back and using the boot when not in use will dramatically increase the life of the top's fabric.

Fabric Care

Use clear water to consistently hose off the fabric top during the boating season.

If necessary, do a deeper clean of the fabric top as follows:

1. If necessary, remove the boot and place the bimini top into its full open position.
2. If the fabric top was stored wet, allow the top and boot to dry.
3. Remove any loose dirt and debris from the top and boot.
4. Hose down the fabric top and boot.

5. Prepare a mixture of ¼ cup of mild dish soap and five gallons of warm water.

NOTE: Do **NOT** use harsh detergents.

6. Use a soft bristle brush to apply the soapy water to the fabric top and boot to remove stains and embedded dirt.
7. Allow the solution time to soak completely into the fabric.
8. Hose off the fabric top and boot with fresh water. Repeat if necessary.
9. Allow the fabric top and boot to dry before closing the top and installing the protective boot.

Storage or Storm Position

When not boating for awhile, secure the fabric top in the zippered storage boot. Folding the pontoon top back into the down or fully collapsed position will increase the top's life.

Winter Storage

To prevent small animals from nesting in the top during the winter, unzip and remove the protective boot. Store the boot and pontoon in a clean dry place to increase the life of the top.

Wiring Diagram

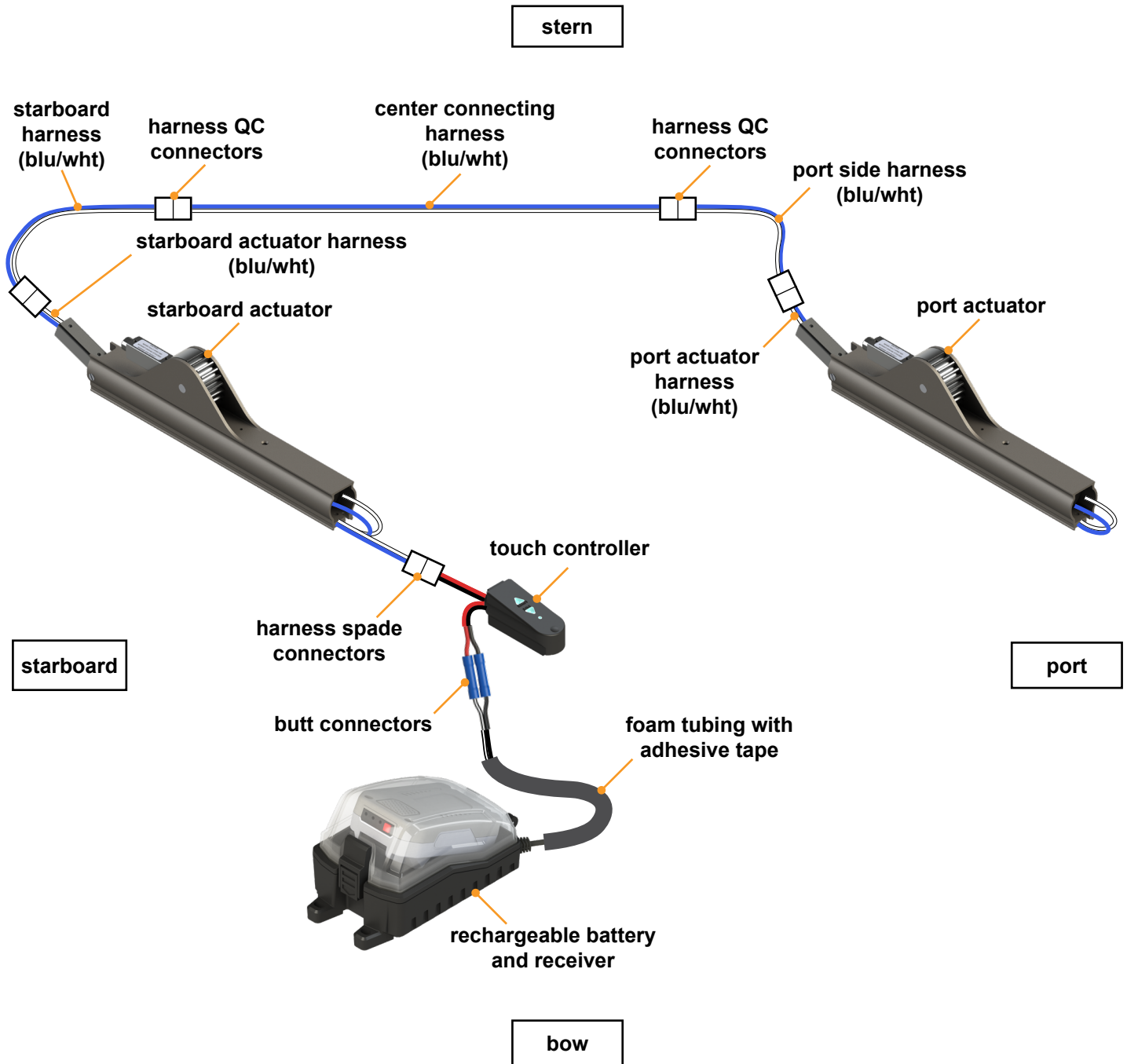



**SureShade™ Bimini System
with QC Battery Pack
Installation and Owner's Manual
(For Aftermarket Applications)**

Notes

Lined area for notes, consisting of two columns of horizontal lines.



**SureShade™ Bimini System
with QC Battery Pack
Installation and Owner's Manual
(For Aftermarket Applications)**

Notes

Lined area for taking notes, consisting of two columns of horizontal lines.



Manual information may be distributed as a complete document only, unless Lippert provides explicit consent to distribute individual parts.

All manual information is subject to change without notice. Revised editions will be available for free download at lippert.com. Manual information is considered factual until made obsolete by a revised version.

Please recycle all obsolete materials and contact Lippert with concerns or questions.